



Marking to ATEX 94/9/EC Directive: Ex II 2 G / Ex e II T6 or T5

Zone: 1, 2, 21, 22 , Gas Group IIC

Compliance with: IEC 60079-0:2004, IEC 60079-7:2001

EC Type Examination Certificate: ISSeP 05 ATEX 067 X



FEATURES

Enclosure: Copper free diecast aluminium alloy suitable for petrochemical and marine locations.

Application: NMA range of enclosures are used with terminals fitted inside as terminal boxes.

Range: Manufactured in a range of sizes for varying number of certified Ex`e` terminals.

IP rating: IP66 by using an oil and petrol resistant neoprene lid gasket for temperature -40 °C to +120 °C.

Cable entry: ISO 965.1 metric as standard. NPT or other threads supplied on request.

Earthing: Standard M6 internal and external earth screw.

Finish: Electrostatic powder coated or two pack epoxy paint.



40

OPTIONS

Stainless steel screws.

Mounting brackets.

نور محور فارس
تولید کننده تجهیزات الکتریکی ضد انفجار
NM SWITCHGEAR
Explosion Proof Electrical Supplies



NMA.. Increased Safety Terminal Boxes

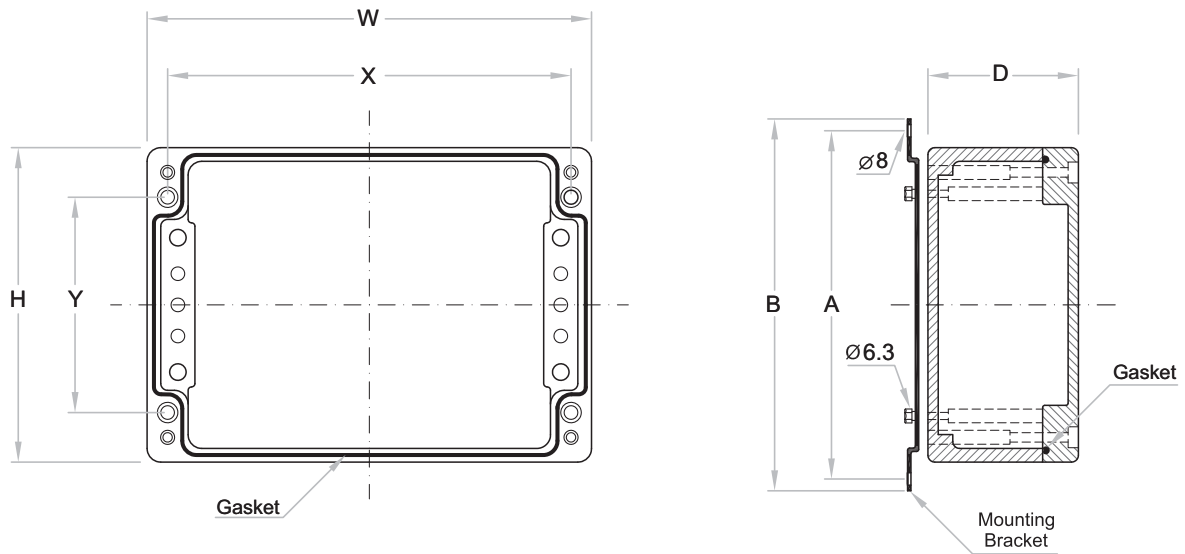

Table 1. NMA range of enclosures and dimensions (in mm)

ENCLOSURE CAT NO.	Overall dimensions					MOUNTING HOLES (A)	MOUNTING BRACKET (B)
	W	H	D	X	Y		
NMA11	122	120	80	106	82	145	175
NMA12	220	120	80	204	82	150	180
NMA14	160	160	90	140	110	190	220
NMA15	260	160	90	240	110	190	220
NMA17	360	160	90	340	110	190	220
NMA18	230	200	110	180	180	230	260
NMA20	330	230	110	310	180	260	290

Dimensions shown are within manufacturing tolerances.

Table 2. Maximum No. of entries per side / Terminal characteristics, No. of poles

ENCL. CAT NO.	ENTRIES (Long side)					ENTRIES (Short side)					Maximum number of terminals allowed				
	M 16	M 20	M 25	M 32	M 40	M 16	M 20	M 25	M 32	M 40	2.5 mm ²	4.0 mm ²	6.0 mm ²	10.0 mm ²	16.0 mm ²
NMA11	6	6	4	2	1	4	4	3	1	1	1 x 14	1 x 10	1 x 7	1 x 6	1 x 5
NMA12	15	14	12	6	4	4	4	3	1	1	1 x 34	1 x 26	1 x 20	1 x 16	1 x 13
NMA14	14	8	8	5	3	8	6	6	2	2	1 x 22	1 x 16	1 x 11	1 x 10	1 x 8
NMA15	27	16	16	11	6	8	6	6	2	2	1 x 41	1 x 33	1 x 23	1 x 20	1 x 16
NMA17	32	24	24	17	9	8	6	6	2	2	1 x 60	1 x 50	1 x 38	1 x 30	1 x 25
NMA18	26	18	15	10	6	21	12	12	8	5	2 x 28	2 x 24	2 x 18	2 x 14	2 x 12
NMA20	38	30	21	18	12	21	12	12	8	5	2 x 54	2 x 40	2 x 34	2 x 27	2 x 22



NMSS ..

Increased Safety Stainless Steel Terminal Boxes



Marking to ATEX 94/9/EC Directive: II 2 G / Ex e II T6 or T5

Zone: 1, 2, 21, 22 , Gas Group IIC

Compliance with: IEC 60079-0:2011, IEC 60079-7:2007, IEC 60079-31:2008

EC Type Examination Certificate: ISSeP 05 ATEX 67X/1

Production quality assurance notification: ISSeP 12 ATEX 026



FEATURES

- Enclosure:** Made of stainless steel suitable for petrochemical and marine locations.
- Application:** NMSS range of enclosures are used with terminals fitted inside as terminal boxes.
- Range:** Manufactured in a range of sizes for varying number of certified Ex'e' terminals.
- IP rating:** IP66 & 67 by using an oil and petrol resistant lid gasket for temperature -40°C to +120°C.
- Cable entry:** Can be punched to suit customer requirements.
- Earthing:** Standard M6 internal and external earth screw.

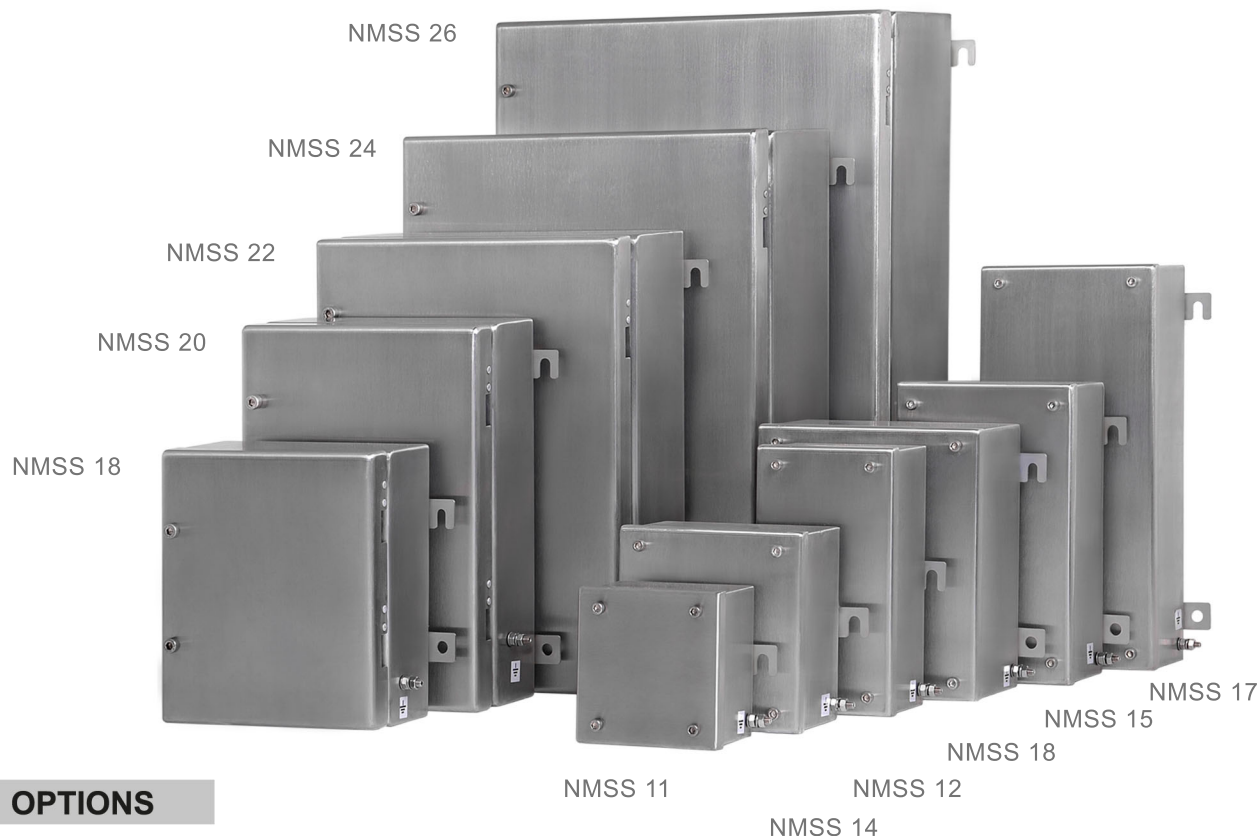

OPTIONS

- Stainless steel screws.
- Mounting brackets.
- Automatic Ex 'd' IIC Gb breather (top side) / drain (bottom side) valve
- Size: M20, C/W: Locknut



نور محور فارس
تولید کننده تجهیزات الکتریکی ضد انفجار
NM SWITCHGEAR
Explosion Proof Electrical Supplies



NMSS.. Increased Safety Stainless Steel Terminal Boxes

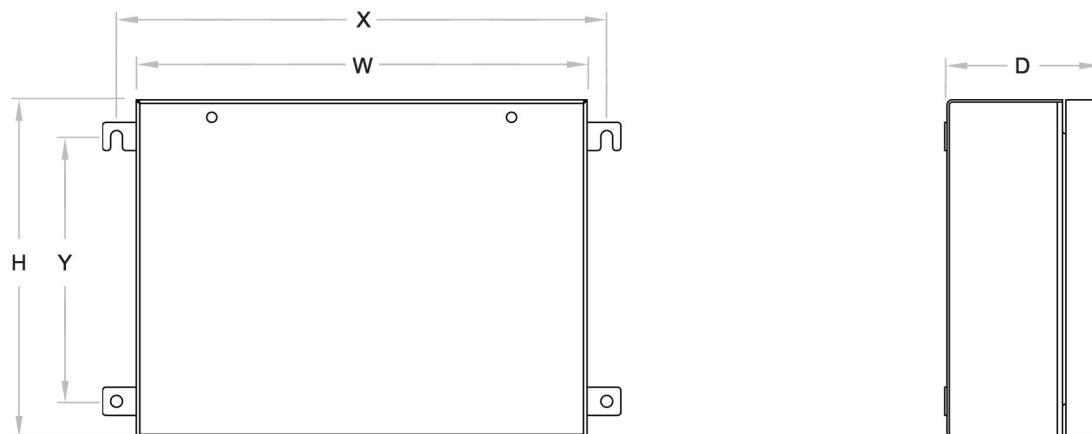

Table 1. NMSS range of enclosures and dimensions (in mm.)

ENCLOSURE CAT No.	Overall dimensions				
	W	H	D	X	Y
NMSS 11	122	120	80	150	----
NMSS 12	220	120	80	250	----
NMSS 14	160	160	90	185	----
NMSS 15	260	160	90	285	----
NMSS 17	360	160	90	385	----
NMSS 18	230	200	110	260	130
NMSS 20	330	230	110	355	155
NMSS 21	330	230	210	355	155

ENCLOSURE CAT No.	Overall dimensions				
	W	H	D	X	Y
NMSS 22	400	300	135	425	225
NMSS 23	400	300	235	425	225
NMSS 24	490	360	165	515	285
NMSS 25	490	360	265	515	285
NMSS 26	600	400	180	625	325
NMSS 27	600	400	280	625	325
NMSS 28	1200	800	400	1225	725
NMSS 29	1200	800	600	1225	725

Dimension shown are within manufacturing tolerances.

ENCL. CAT. No.	ENTRIES (Long side)												ENTRIES (Short side)												MAXIMUM NUMBER OF TERMINALS ALLOWED														
	M 16	M 20	M 25	M 32	M 40	M 50	M 63	M 75	M 80	M 90	M 100	M 16	M 20	M 25	M 32	M 40	M 50	M 63	M 75	M 80	M 90	M 100	2.5 mm ²	4.0 mm ²	6.0 mm ²	10.0 mm ²	16.0 mm ²	35.0 mm ²	50.0 mm ²	70.0 mm ²	95.0 mm ²	120.0 mm ²	150.0 mm ²	240.0 mm ²					
NMSS 11	6	3	2	1	-	-	-	-	-	-	4	3	1	1	-	-	-	-	-	-	-	1x16	1x14	1x12	1x10	---	---	---	---	---	---	---	---	---	---	---			
NMSS 12	9	5	4	3	-	-	-	-	-	-	6	3	2	2	-	-	-	-	-	-	-	1x33	1x30	1x25	1x20	---	---	---	---	---	---	---	---	---	---	---			
NMSS 14	8	6	2	1	-	-	-	-	-	-	10	8	3	2	-	-	-	-	-	-	-	1x24	1x21	1x17	1x14	1x11	---	---	---	---	---	---	---	---	---	---			
NMSS 15	16	12	5	4	3	-	-	-	-	-	10	8	3	2	2	-	-	-	-	-	-	1x40	1x36	1x30	1x24	1x19	---	---	---	---	---	---	---	---	---	---			
NMSS 17	22	15	7	6	4	-	-	-	-	-	10	8	3	2	-	-	-	-	-	-	-	1x56	1x52	1x42	1x34	1x27	---	---	---	---	---	---	---	---	---	---			
NMSS 18	16	12	10	8	6	4	-	-	-	-	12	8	8	6	2	-	-	-	-	-	-	2x32	2x30	2x25	2x20	2x16	2x12	1x10	---	---	---	---	---	---	---	---			
NMSS 20	38	14	8	7	6	3	2	-	-	-	21	8	5	3	3	2	1	-	-	-	-	2x50	2x46	2x38	2x30	2x24	1x18	1x15	1x14	---	---	---	---	---	---	---	---		
NMSS 21	120	32	20	12	8	6	3	2	2	2	1	70	20	23	6	6	5	3	2	2	1	1	2x50	2x46	2x38	2x30	2x24	1x18	1x15	1x14	---	---	---	---	---	---	---	---	
NMSS 22	48	36	28	24	16	9	7	5	-	-	36	24	18	14	8	6	5	3	-	-	-	2x62	2x56	2x46	2x37	2x29	2x24	2x19	1x14	1x14	1x14	---	---	---	---	---	---	---	
NMSS 23	171	78	36	38	26	12	9	8	4	4	2	84	38	26	24	18	9	6	8	4	2	1	2x62	2x56	2x46	2x37	2x29	2x24	2x19	1x14	1x14	1x14	---	---	---	---	---	---	---
NMSS 24	86	49	42	38	28	18	11	7	6	4	3	42	24	20	17	15	10	7	4	3	2	1	2x76	2x70	2x58	2x46	2x36	2x28	2x24	1x22	1x18	1x17	1x14	1x14	1x12	1x12	1x12	1x12	
NMSS 25	196	76	72	54	42	32	21	15	12	9	5	78	46	36	32	26	21	15	9	6	5	3	2x76	2x70	2x58	2x46	2x36	2x28	2x24	1x22	1x18	1x17	1x14	1x14	1x14	1x15	1x15	1x15	
NMSS 26	124	74	62	46	30	22	14	9	9	6	4	48	32	28	24	16	11	8	5	5	3	2	2x95	2x88	2x72	2x57	2x45	2x36	2x30	2x27	1x22	1x21	1x18	1x18	1x18	1x18	1x18	1x18	
NMSS 27	222	102	86	78	54	38	24	15	15	9	6	74	58	46	36	28	21	14	9	9	5	3	2x95	2x88	2x72	2x57	2x45	2x36	2x30	2x27	1x22	1x21	1x18	1x18	1x18	1x18	1x18	1x18	
NMSS 28	1003	788	378	288	184	86	78	64	48	36	27	436	338	248	194	86	54	42	33	27	15	12	3x200	3x174	2x138	2x105	2x92	2x70	2x56	2x52	1x42	1x40	1x36	1x36	1x28	1x28			