



Marking to ATEX 94/9/EC Directive: Ex II 2 G Ex d IIB+H₂T6 or T5 Gb / II 2 D Ex tb IIIC T80°C or T95°C Db IP6X

Zone: 1, 2, 21, 22 , Gas Group IIB +H₂

Compliance with: EN 60079-0:2009 (IEC 60079-0:2007), EN/IEC 60079-1:2007,
EN 60079-31:2009, IEC 60079-31:2008

EC Type Examination Certificate: ISSeP 10 ATEX 017X/1



FEATURES

Application: For operation of motors and a wide range of electrical equipments.

Enclosure: Copper free aluminium alloy suitable for petroleum and marine locations. Cast iron on request.

Range: Emergency stop, start - stop, rotary switch, signal lamp, ammeter or other components can be used in any configuration to suit various requirements. Type of enclosures used is from EJBT (Exd IIB+H₂) range.

IP rating: IP65 to IEC 529 by application of an approved non-hardening grease for added resistance to ingress of dust and moisture. IP66 & IP67 supplied on request.

Cable entry: ISO 965.1 metric as standard. NPT or other threads supplied on request.

Earthing: Standard M6 internal and external earth screws. Larger sizes on request.

Finish: Electrostatic powder coated or two pack epoxy paint.



OPTIONS

Stainless steel screws.

Mounting brackets.

Cable gland or stopping plug.

Larger size than M6 earth screw.

Cast iron enclosure.

نور محور فارس
تولید کننده تجهیزات الکتریکی ضد انفجار

NM SWITCHGEAR
Explosion Proof Electrical Supplies



EJBC.. control and signalling boxes

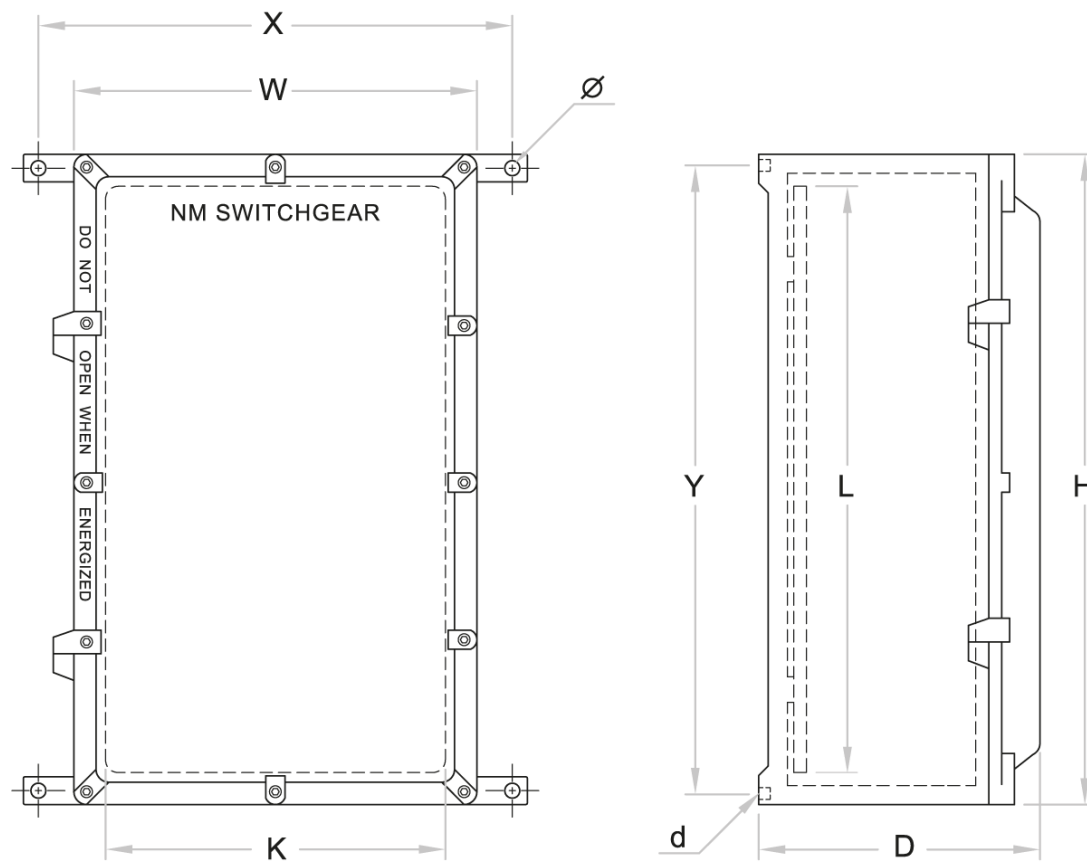

Table 1. EJBC range of enclosures and dimensions (in mm)

Enclosures always available in stock

ENCLOSURE	OVERALL DIMENSIONS			MOUNTING DETAILS				MOUNTING PALTE		WEIGHT KGS.
	W	H	D	X	Y	d	Ø	K	L	
CAT NO.	W	H	D	X	Y	d	Ø	K	L	
EJBC 10	140	220	111	180	198	M6	8	88	177	3.9
EJBC S1	181	256	184	210	230	M8	10	120	200	7.1
EJBC S2	231	441	196	272	407	M8	10	167	375	15.5
EJBC 3	267	344	279	302	308	M8	10	195	275	21.2
EJBC 4R	325	430	222	370	362	M10	12	255	345	23.5
EJBC 5	442	645	327	480	587	M10	12	350	565	57.4

Enclosures manufactured on request

ENCLOSURE	OVERALL DIMENSIONS			MOUNTING DETAILS				MOUNTING PALTE		WEIGHT KGS.
	W	H	D	X	Y	d	Ø	K	L	
CAT NO.	W	H	D	X	Y	d	Ø	K	L	
EJBC 15	140	220	164	180	198	M6	8	88	177	4.8
EJBC 1	130	440	157	160	420	M8	10	75	380	10.2
EJBC 2	200	400	196	225	370	M8	10	130	335	14.4
EJBC 3R	267	344	222	302	308	M8	10	195	257	16.8
EJBC 4	325	430	282	370	361	M10	12	255	345	30.4
EJBC 5R	442	645	240	480	587	M10	12	350	565	44.0

Dimensions shown are within manufacturing tolerances

نور محور فارس
NM SWITCHGEAR



Marking to ATEX 94/9/EC Directive: Ex II 2 G Ex d IIC T6 or T5 Gb / II 2 D Ex tb IIIC T80°C or T95°C Db IP6X

Zone: 1, 2, 21, 22 , Gas Group IIC

Compliance with: EN 60079-0:2009 (IEC 60079-0:2007), EN/IEC 60079-1:2007, EN 60079-31:2009, IEC 60079-31:2008

EC Type Examination Certificate: ISSeP 10 ATEX 017X



FEATURES

Application: For operation of motors and a wide range of electrical equipments.

Enclosure: Copper free aluminium alloy suitable for petroleum and marine locations. Cast iron on request.

Range: Emergency stop, start - stop, rotary switch, signal lamp, ammeter or other components can be used in any configuration to suit various requirements. Type of enclosures used is from GUBST (Exd IIC) range.

IP rating: IP65 to IEC 529 by application of an approved non-hardening grease for added resistance to ingress of dust and moisture. IP66 & IP67 supplied on request.

Cable entry: ISO 965.1 metric as standard. NPT or other threads supplied on request.

Earthing: Standard M6 internal and external earth screws. Larger sizes on request.

Finish: Electrostatic powder coated or two pack epoxy paint.



OPTIONS

Stainless steel screws.

Cable gland or stopping plug.

Larger size than M6 earth screw.

Cast iron enclosure.



Typical examples of Exd IIC Control Stations

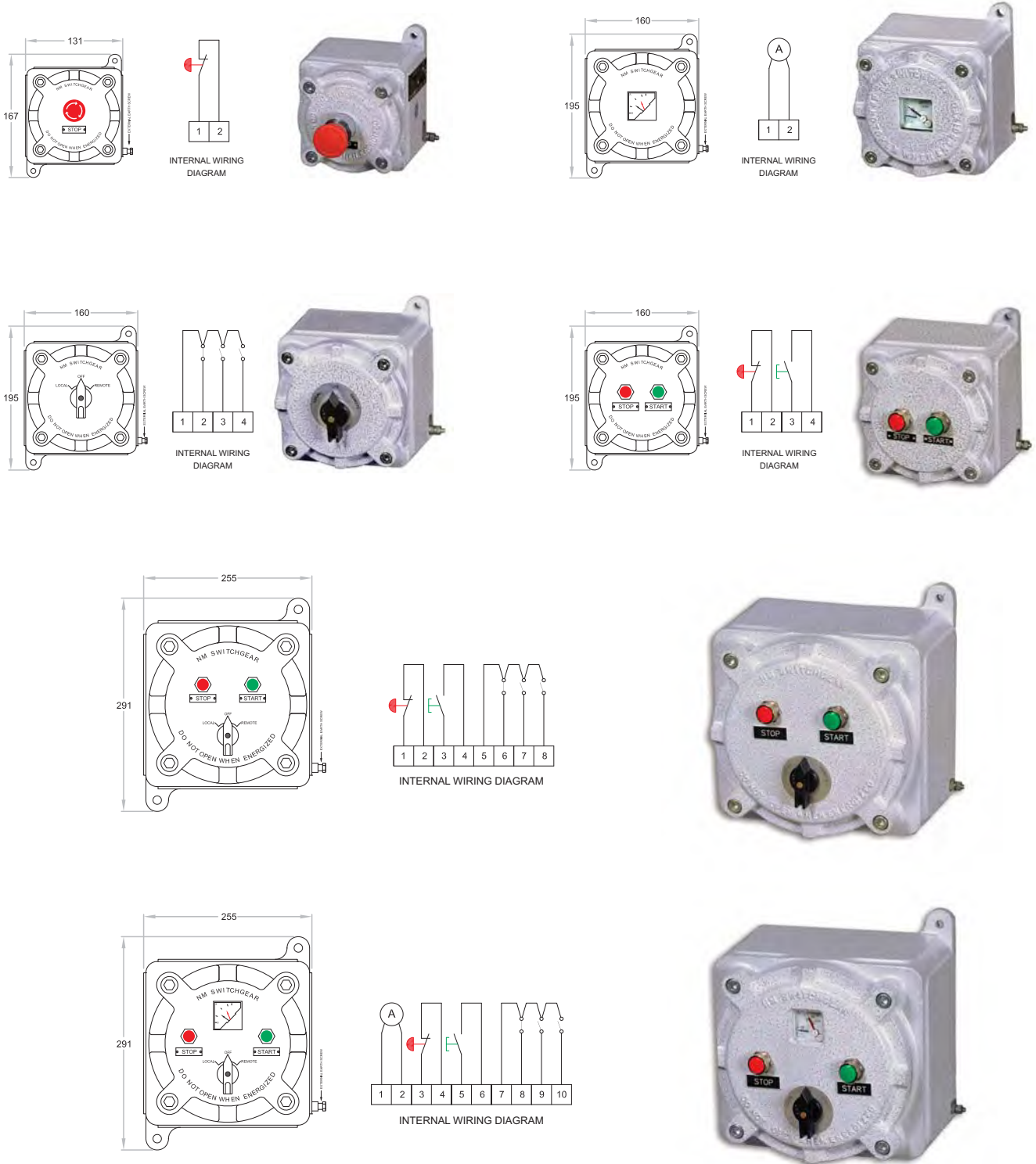

GUBSC.. Control and Signalling Boxes

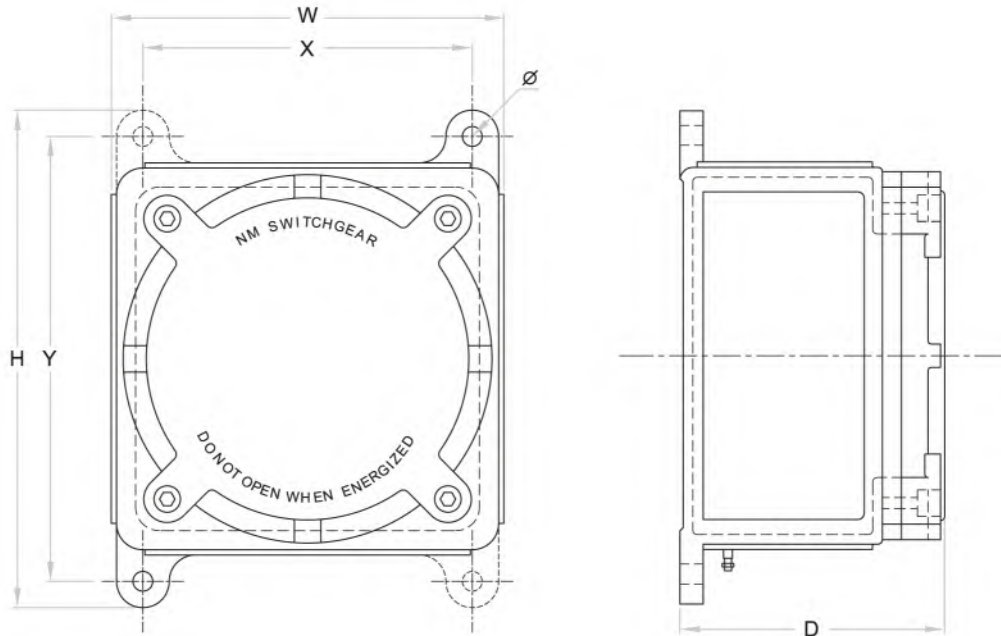

Table 1. GUBSC range of enclosures and dimensions (in mm)

ENCLOSURE	OVERALL DIMENSIONS			MOUNTING DETAILS				WEIGHT KGS.
	W	H	D	X	Y	∅	NO. OF LUGS	
CAT NO.								
GUBSC1	131	167	125	97	151	8	2	2.7
GUBSC2	160	195	135	125	174	8	2	3.8
GUBSC3	181	220	138	150	193	8	2	4.2
GUBSC4	255	291	174	217	260	10	2	9.8
GUBSC5	318	378	245	275	337	14	4	19.2

Dimensions shown are within manufacturing tolerances